

PLAN SHOWING THE PROPOSED SUB-DIVISION  
 IN R.S. NO 95/2A OF PEERKANKARANAI VILLAGE  
 SAIDAPET TK & CHENGALPATTU DIST.

TAMBARAM SUB-REGISTRAR OFFICE. SCALE 1" = 160'

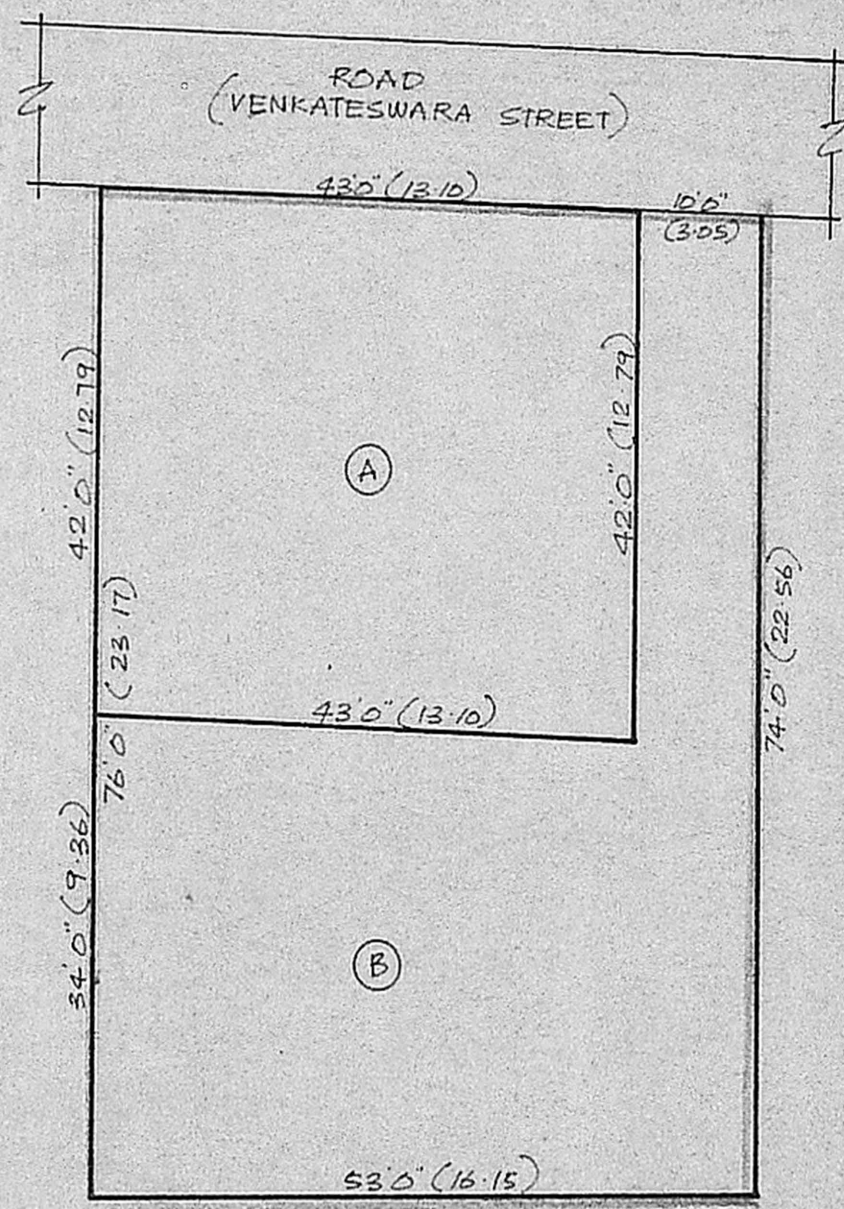

**APPROVED**  
 VIDE Lr. No. D2(L)/848/89  
 Dtd.....7.8.89

P.P.D No: 174/89

FOR MEMBER SECRETARY  
 MADRAS METROPOLITAN  
 DEVELOPMENT AUTHORITY

27/7/89  
 2/3/8

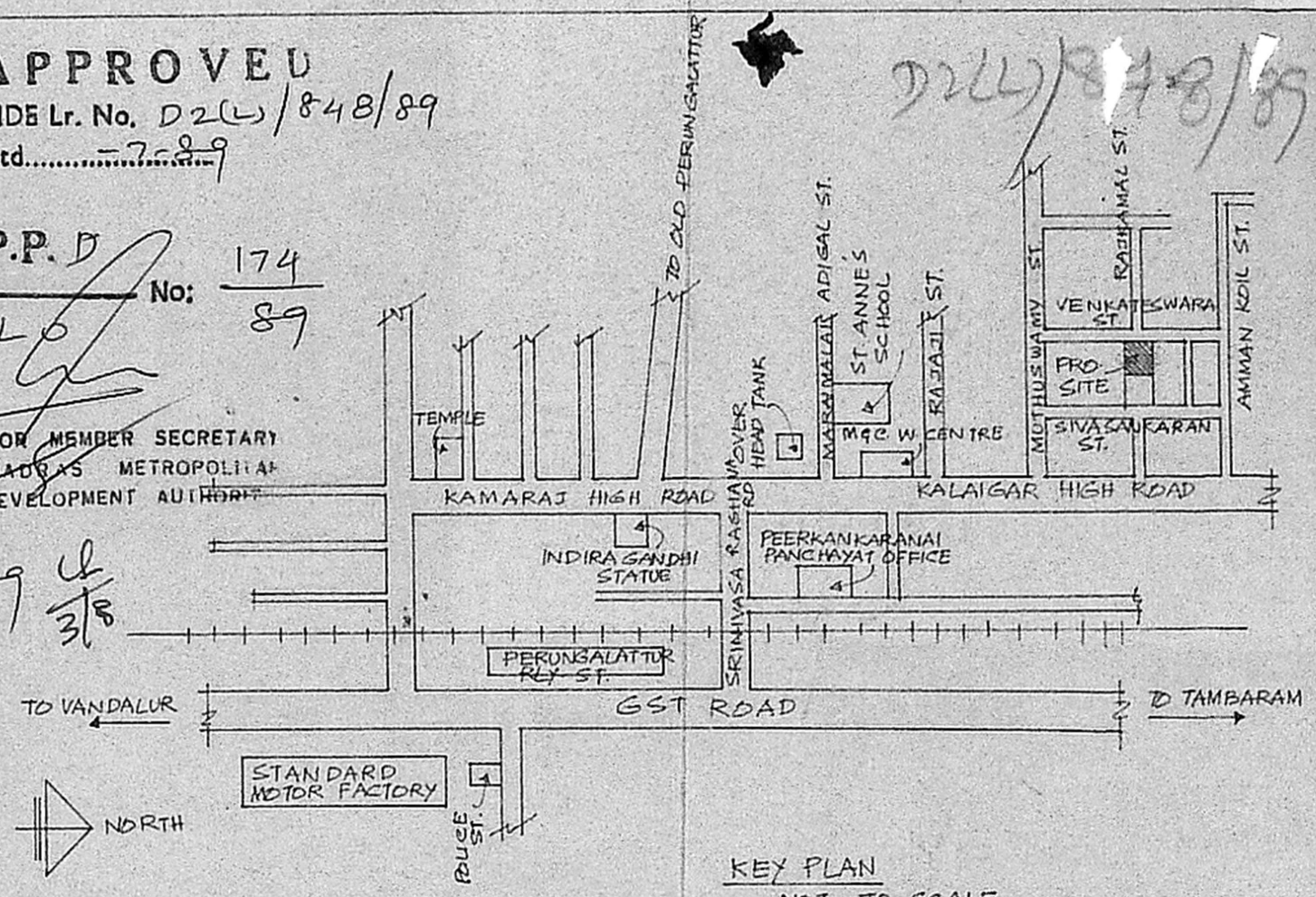

KEY PLAN  
 NOT TO SCALE

NOTE 8-

	SQ FT.	SQ M.
TOTAL EXTENT	3975	369.19
PORTION-A	1806	167.54
PORTION-B	2169	201.65
PROPOSED SUB-DIVISION		
EXISTING ROAD		

*V. Srinivasulu*  
**V. SRINIVASULU, L.C.E.**  
 Asst. Executive Engineer (Retd)  
 Consulting Civil Engineer,  
 REGD. No. 270.  
**CLASS I LICENSED SURVEYOR**  
 CORPORATION OF MADRAS  
 No. 60, Valluvar Road,  
 ARUMBAKKAM, MADRAS-16

R. Anantharaman  
 OWNER

ENGINEER